

**Ground Support Heavy Duty Spigoted 12 x 11 m Flat**

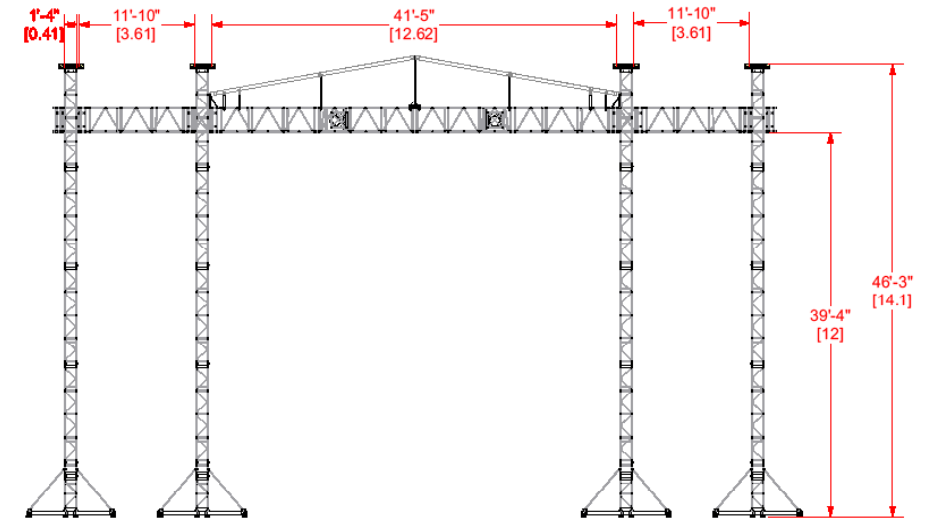

- En truss HD 20.5"x 30" / 52 x 76 cm
- Altura torre: 14.10 m / 46ft - 3"
- Altura libre: 12 m / 39ft - 4"
- 6 torres en área de escenario en Truss Spigoted 16" x 16" / 40 x 40 cm
- 3 travesaños Cross Stage en Truss HD de 20.5"x 30" / 52 x 76 cm
- 2 torres para FLY en Truss Spigoted 16" x 16" - 40 x 40 cm



VISTA FRONTAL

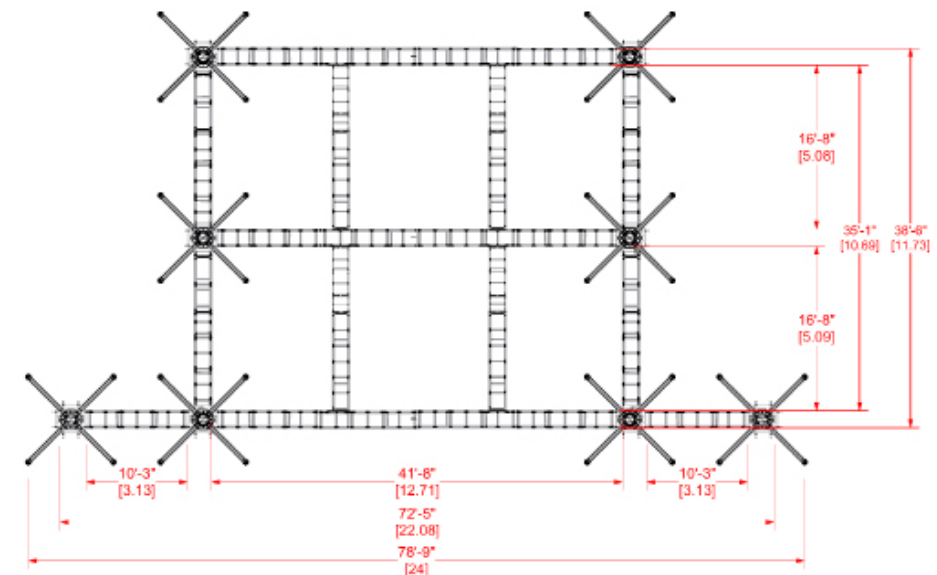

VISTA SUPERIOR

Ground Support 12 x 11  
Heavy Duty Spigoted Flat